

SEC:A-A

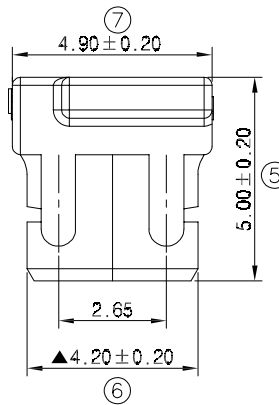

SEC:B-B

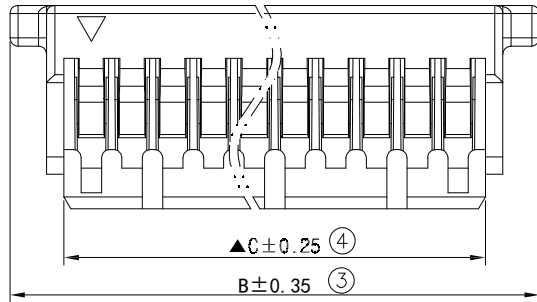
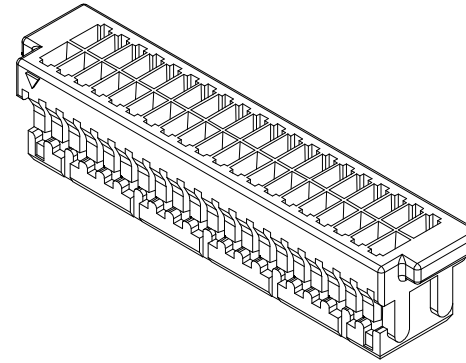
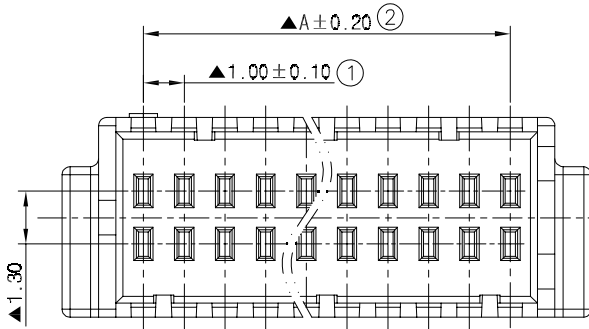

- 技术参数 SPECIFICATIONS**
- 额定电压: 250V DC/AC (有效值)
Voltage rating: 250V DC/AC (rms)
 - 额定电流: 1.0A
Current rating: 1.0A
 - 耐压值: 800V AC(有效值)
Withstand voltage: 800V AC(rms)
 - 工作温度: -25℃~+85℃
Working Temperature: -25℃+85℃
 - 绝缘电阻: ≥1000MΩ
Insulation resistance: ≥1000MΩ
 - 接触电阻: ≤0.02Ω
Contact resistance: ≤0.02Ω
 - 数量: 1k/袋
QTY: 1000PCS/BAG
 - 线号: #28-#32
Wire Rang: #28-#32

| Circuit No. | Dimensions | | |
|-------------|------------|-------|-------|
| | A | B | C |
| 2X04P | 3.00 | 7.00 | 4.35 |
| 2X05P | 4.00 | 8.00 | 5.35 |
| 2X06P | 5.00 | 9.00 | 6.35 |
| 2X07P | 6.00 | 10.00 | 7.35 |
| 2X08P | 7.00 | 11.00 | 8.35 |
| 2X09P | 8.00 | 12.00 | 9.35 |
| 2X10P | 9.00 | 13.00 | 10.35 |
| 2X11P | 10.00 | 14.00 | 11.35 |
| 2X15P | 14.00 | 18.00 | 15.35 |
| 2X20P | 19.00 | 23.00 | 20.35 |
| 2X25P | 24.00 | 28.00 | 25.35 |

EST1001 H - 2*NP X - B - NK - HF-X-X

异通代码+间距 1示意单排 2示意双排 X本色 B黑色 R红色 L蓝色 Y黄色 G绿色 PIN数
 H示意胶壳, H后无数字默认材质V0 H后带数字2示意材质V2 X普通 B带扣 C刺破 L示意 LOCK TYPE U超薄 F防呆型 HV带高凸点, LC带低凸点, K卡槽 E有耳 NE无耳
 X公胶壳 G母胶壳 A灼热丝750 B灼热丝850 X普通料 HP示意无卤 NF普通含卤



东莞市羿通实业有限公司
DONGGUAN EASTOM ELECTRONIC Co., Ltd.

料号PART NO: EST1001H-2*NPX-E-X

品名 TITLE: SH1.0-HC(双排)

材料: 单位: MM 包装规格: 比例: 1:1

日期版次 REVISION 日期 DATE 变更内容 DESCRIPTION 核 准 APPROVALBY 制图: 审核: 核准: 日期: 2022. 4. 10

一般公差
GENERAL TOLERANCE
X.X ±0.30
X.XX ±0.20
ANGLE ±1°

