

13790510059

5

4

3

2

1

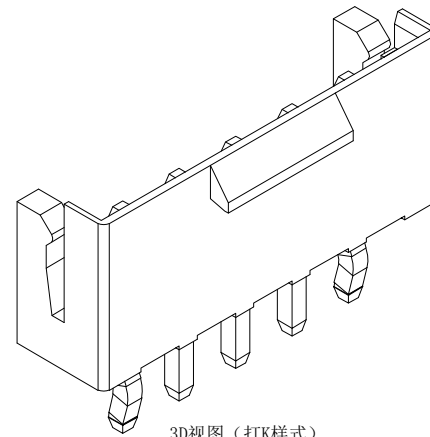
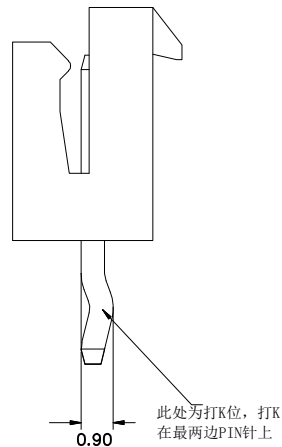
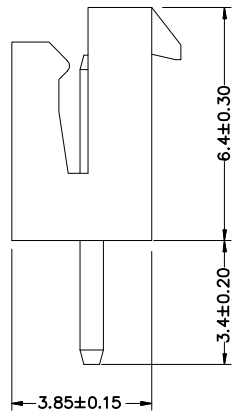
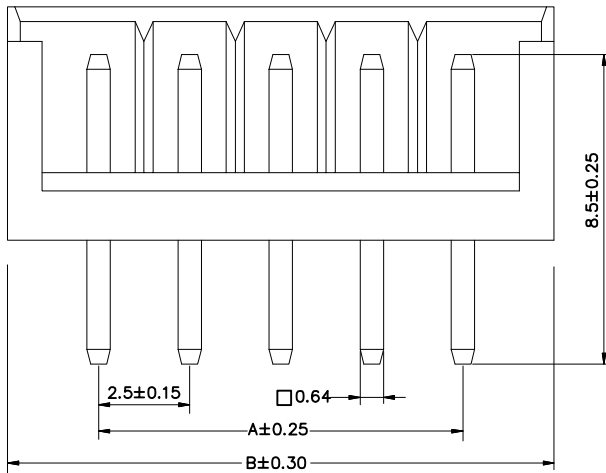
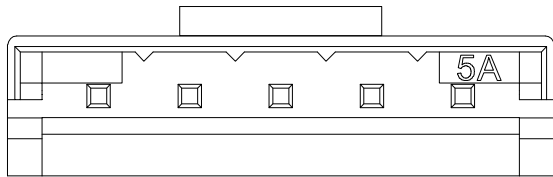

Poles	Dimensions mm	
	A	B
2	2.50	7.5
3	5.00	10.00
4	7.50	12.50
5	10.00	15.00
6	12.50	17.50
7	15.00	20.00
8	17.50	22.50
9	20.00	25.00
10	22.50	27.50
11	25.00	30.00
12	27.50	32.50
13	30.00	35.00
14	32.50	37.50
15	35.00	40.00
16	37.50	42.50

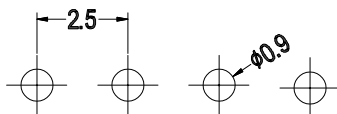

P.C.B LAYOUT

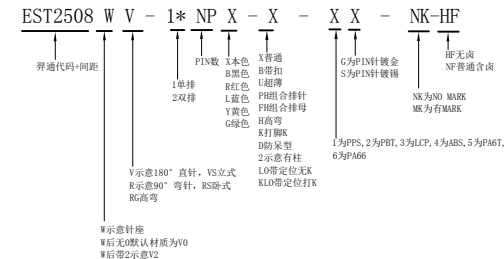

说明:

- 1、产品料号: EST2508WV-1\*NPX-B;
- 2、塑胶材质: PA66 UL94-V0;
- 3、PIN针: C2680镀锡;
- 4、额定电压: 250V AC/DC;
- 5、额定电流: 2.5A;
- 6、耐压值: 800V AC/Minute;
- 7、接触电阻: 10mΩ (MAX);
- 8、绝缘电阻: 1000MΩ (MIN);
- 9、使用温度: -25℃~+85℃;



东莞市羿通实业有限公司  
DONGGUAN EASTOM ELECTRONIC Co., Ltd.

料号PART NO: EST2508WV-1\*NPX-B

品名 TITLE: EH2.5-Wafer (180° 有扣)

材料: 单位: MM 包装规格: 比例: 1:1  
 制图: 审核: 核准: 日期: 2022.06.08

一般公差  
GENERAL TOLERANCE  
 X.X ±0.30  
 X.XX ±0.20  
 ANGLE ±1°

日期版次 REVISION	日期 DATE	变更内容 DESCRIPTION	核 准 APPROVALBY

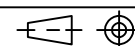

6

5

4

3

2

1

YL