

13790510059

5

4

3

2

1

Poles	Dimensions/mm				
	A	E	B	C	D
2	2.50	5.70	3.90	7.40	
3	5.00	8.20	6.40	9.90	
4	7.50	10.70	8.90	12.40	
5	10.00	13.20	11.40	14.90	
6	12.50	15.70	13.90	17.40	
7	15.00	18.20	16.40	19.90	
8	17.50	20.70	18.90	22.40	
9	20.00	23.20	21.40	24.90	
10	22.50	25.70	23.90	27.40	
11	25.00	28.20	26.40	29.90	
12	27.50	30.70	28.90	32.40	
13	30.00	33.20	31.40	34.90	
14	32.50	35.70	33.90	37.40	
15	35.00	38.20	36.40	39.90	

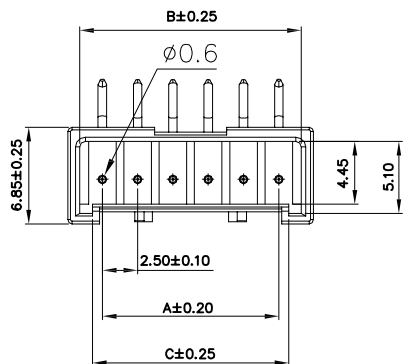
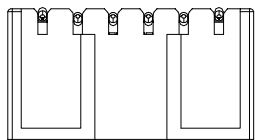

A VIEW

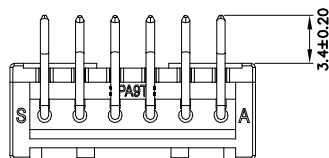
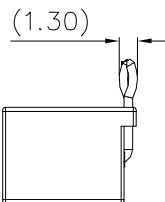

EST2519 W V - 1*NP X - X - X X - NK-HF

↑ 普通代码+间距 ↑ PIN数 ↑ X本色 ↑ X普通
 ↑ B黑色 ↑ U超薄 ↑ G为PIN针镀金 ↑ HF无卤
 ↑ S为PIN针镀锡 ↑ PH组合排针 ↑ S为PIN针镀锡 ↑ NF普通含卤
 ↑ 1单排 ↑ R红色 ↑ 1为PPS, 2为PBT, 3为LCP, 4为ABS, 5为PA6T, 6为PA66
 ↑ 2双排 ↑ L蓝色 ↑ PH组合排母 ↑ NK为NO MARK
 ↑ Y黄色 ↑ H高弯 ↑ K打眼K ↑ MK为有MARK
 ↑ G绿色 ↑ D扇形 ↑ 2示意有柱 ↑ LO带定位无K
 ↑ V示意180°直针, VS立式 ↑ LO带定位有K
 ↑ R示意90°弯针, RS卧式 ↑ KLO带定位打K
 ↑ RG高弯

W示意针座
 W后无0默认材质为V0
 W后带2示意V2

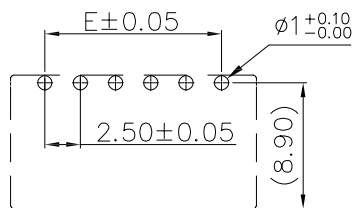
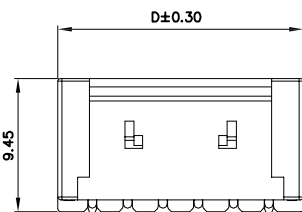

Recommended P.C.B Layout(T=1.6mm)

A VIEW (Lock configuration)

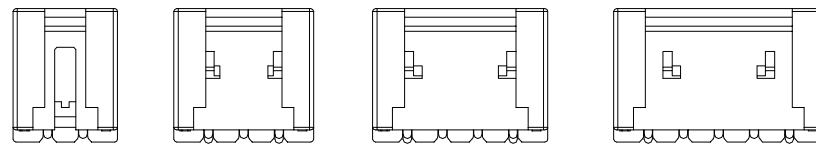

2 Pin

3 Pin

4 Pin

5~15 Pin

Specifications:

- Voltage rating: 250V Max AC/DC
- Current rating: 3.5A AC/DC
- Withstanding voltage: 1000V AC/minute
- Temperature range: -25°C~+ 85°C
- Insulation resistance: ≥1000MΩ
- Contact resistance: ≤20mΩ
- After environmental testing: ≤40mΩ
- Product Specification:



东莞市羿通实业有限公司
 DONGGUAN EASTOM ELECTRONIC Co., Ltd.

料号PART NO: EST2519WR-1*NPX-X

品名 TITLE: 2519单排弯针

材料:

单位: MM

包装规格:

比例: 1:1

制图:

审核:

核准:

日期: 2022/7/3

一般公差
 GENERAL TOLERANCE
 X.X ±0.25
 X.XX ±0.20
 ANGLE ±1°

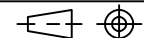

日期版次 REVISION	日期 DATE	变更内容 DESCRIPTION	核 准 APPROVALBY

6

5

4

3

2

1

SL