

a-a SECTION

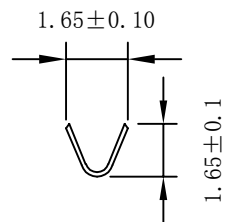

b-b SECTION

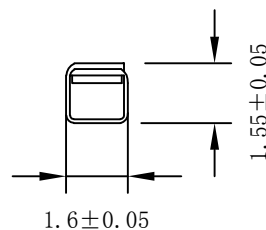
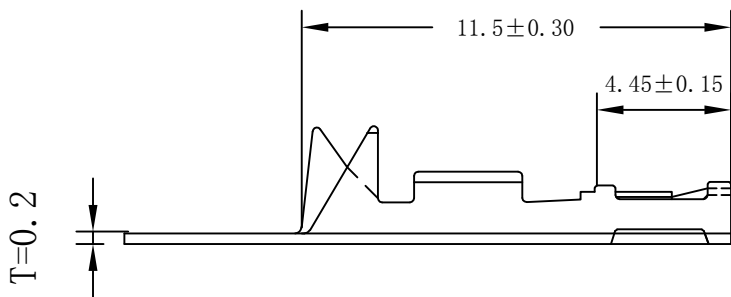

EST2504 T B X - 2 X - X

↑ 羿通代码+间距 ↑ T示意端子 ↑ X普通脚 ↑ H高脚 ↑ E增高脚 ↑ 0素材 ↑ P磷铜 ↑ B黄铜 ↑ E合金铜

↑ X普通 ↑ L长 ↑ S短 ↑ X公端 ↑ G母端

2镀锡先冲后镀 3镀锡先镀后冲 5G、15G示意镀金5U"或15U", 1G示意镀金1U"

SPECIFICATIONS

- Applicable wire:AWG#22~#28
- Voltage rating: 250V DC/AC (rms)
- Current rating:2.0A
- Withstand voltage: 800V AC(rms)
- Working Temperature:-25℃+85℃
- Insulation resistance:≥1000MΩ
- Contact resistance:≤0.02Ω



东莞市羿通实业有限公司
DONGGUAN EASTOM ELECTRONIC Co., Ltd.

料号PART NO: EST2504TBX-2X-G1

品名 TITLE: DB2.54-TC1

材料:	单位: MM	包装规格: 10K/卷	比例: 1:1
制图: 李建	审核: 李园	核准: 李海平	日期: 2022/07/18

一般公差
 GENERAL TOLERANCE
 X.X ±0.25
 X.XX ±0.20
 X.XXX ±0.05
 ANGLE ±1°

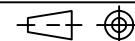

日期版次 REVISION	日期 DATE	变更内容 DESCRIPTION	核 准 APPROVALBY