

13790510059

5

4

3

2

1

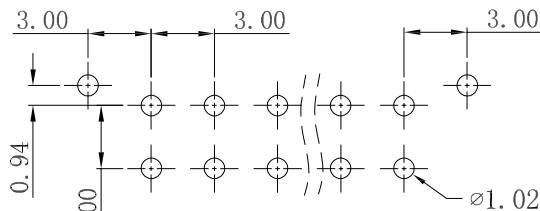
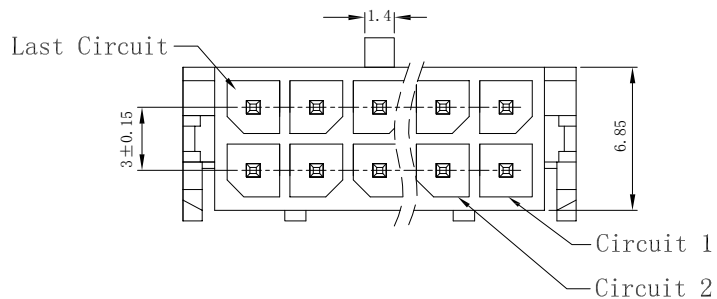

P. C. B. LAYOUT

EST3001 W V - 1\*NP B - K - X X - NK-HF

羿通代码+间距  
 W 示意针座  
 V 示意180°直针, VS立式  
 1单排  
 2双排  
 NP 示意90°弯针, RS卧式  
 B 示意180°直针, VS立式  
 K 示意90°弯针, RS卧式  
 X 普通  
 B 黑色  
 R 红色  
 L 蓝色  
 Y 黄色  
 G 绿色  
 X 普通  
 B 带扣  
 U 超薄  
 PH 组合排针  
 FH 组合排母  
 H 高弯  
 K 打脚  
 D 防呆型  
 2 示意有柱  
 L 带定位无K  
 KLO 带定位打K  
 X X 示意  
 G 为PIN针镀金  
 S 为PIN针镀锡  
 NK-HF 示意  
 NF 普通含卤  
 NK 为NO MARK  
 MK 为有MARK  
 1 为PPS, 2 为PBT, 3 为LCP, 4 为ABS, 5 为PA6T, 6 为PA66  
 W 后带2示意V2

2\*01P-2\*06P B±0.30  
 2\*07P-2\*12P B±0.35

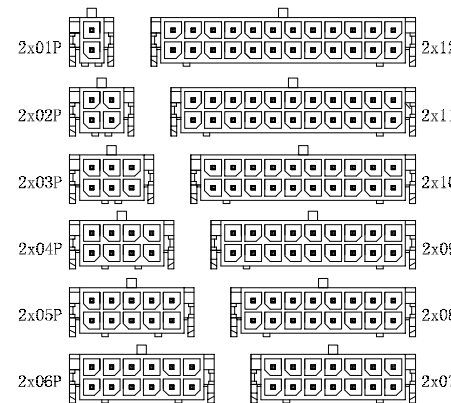
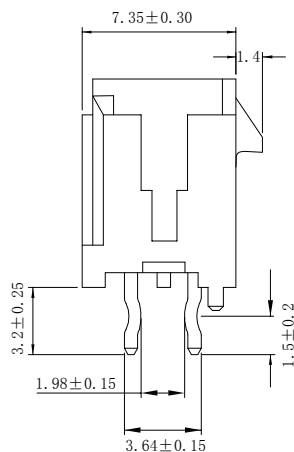
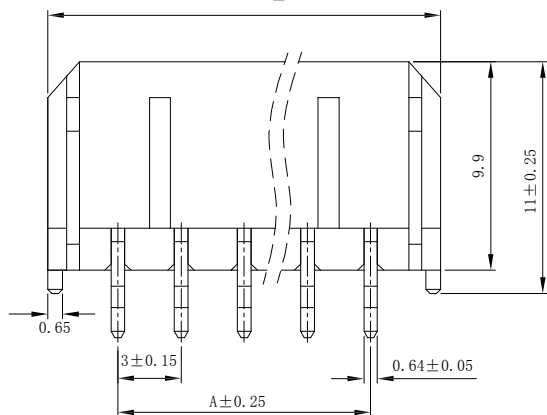

CIRCUIT SIZE LAYOUT

Poles	Dimensions (mm)	
	A	B
02	—	6.65
04	3.00	9.65
06	6.00	12.65
08	9.00	15.65
10	12.00	18.65
12	15.00	21.65
14	18.00	24.65
16	21.00	27.65
18	24.00	30.65
20	27.00	33.65
22	30.00	36.65
24	33.00	39.65

■ SPECIFICATIONS

- Voltage rating: 250V AC, DC
- Current rating: 5A, AC, DC
- Withstanding Voltage: 1500V AC/minute
- Insulation resistance: 1000MΩ min
- Temperature range: -25° C~+85° C
- Contact resistance: 20mΩ max

■ WAFER

- Part No. :
- Poles : 02-24P
- Housing Material: PA66 15%GF UL94V-0 Black
- Pin Material: Brass
- Contact Area Plating: Tin-Plated
- The Dimension Marked "▼" Must Be Recorded

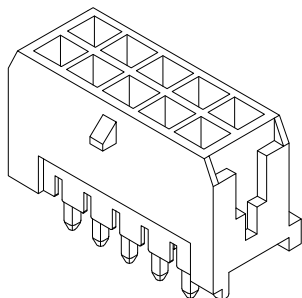

东莞市羿通实业有限公司  
 DONGGUAN EASTOM ELECTRONIC Co., Ltd.

料号PART NO: EST3001WV-2\*NPX-2

品名 TITLE: MX3.0直针双打K

材料: 单位: MM 包装规格: 比例: 1:1  
 制图: 审核: 核准: 日期: 2022.8.1

一般公差  
 GENERAL TOLERANCE  
 X.X ±0.25  
 X.XX ±0.20  
 ANGLE ±1°

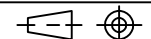

日期版次 REVISION	日期 DATE	变更内容 DESCRIPTION	核 准 APPROVALBY

6

5

4

3

2

1

XY