

13790510059

5

4

3

2

1

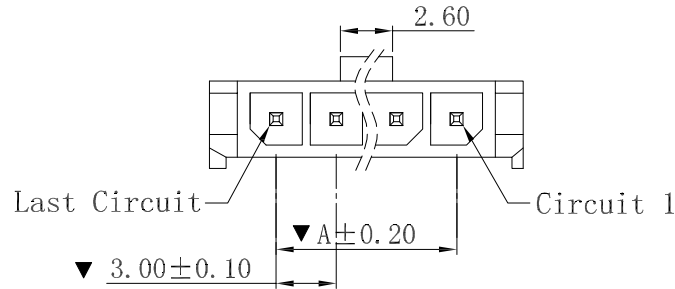
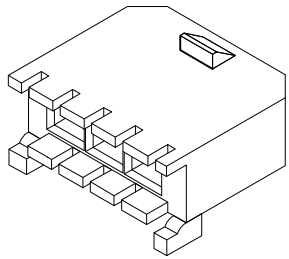

■ SPECIFICATIONS

- Voltage rating: 250V AC, DC
- Current rating: 5A, AC, DC
- Withstanding Voltage: 1500V AC/minute
- Insulation resistance: 1000MΩ min
- Temperature range: -25° C~+85° C
- Contact resistance: 20mΩ max

■ WAFER

- Part No. :
- Poles : 02-12P
- Housing Material: PA66 15%GF UL94V-0 Black
- Ter Material: Brass
- Solder Tabs Material: Brass
- Contact Area Plating: Tin-Plated
- The Dimension Marked "▼" Must Be Recorded

F

F

E

E

D

D

C

C

B

B

A

A

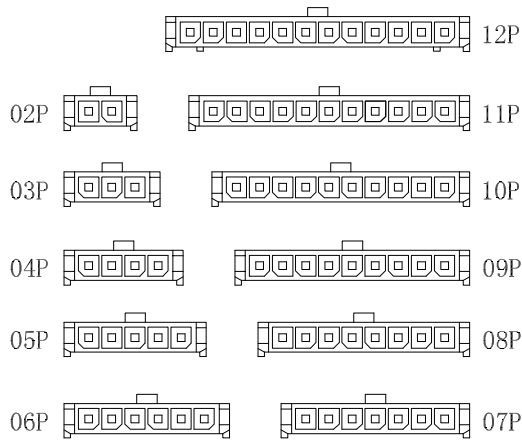

CIRCUIT SIZE LAYOUT

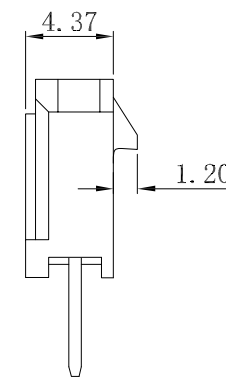
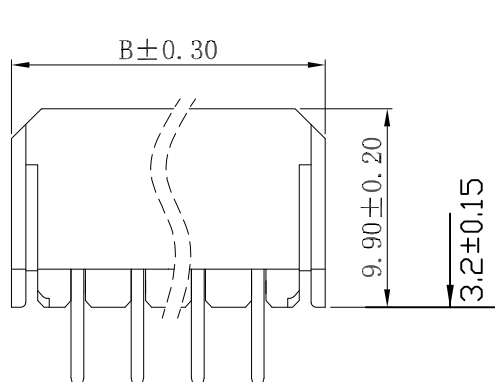

Poles	Dimensions (mm)	
	A	B
02	3.00	9.65
03	6.00	12.65
04	9.00	15.65
05	12.00	18.65
06	15.00	21.65
07	18.00	24.65
08	21.00	27.65
09	24.00	30.65
10	27.00	33.65
11	30.00	36.65
12	33.00	39.65

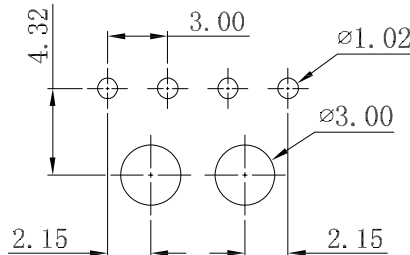

P. C. B. LAYOUT 04P-12P

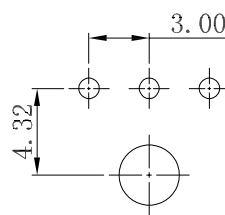

PCB. LAYOUT: 03P

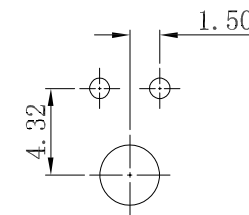

PCB. LAYOUT: 02P

EST3001 W V - 1*NP B - B - 6S - NK-HF

↑ 异通代码+间距 ↑ PIN数 X本色 X普通
 1单排 B黑色 B带扣 2双排 R红色 U超薄 L蓝色 PH组合排针 Y黄色 FH组合排母 G绿色 H高弯

↑ V示意180°直针, VS立式 R示意90°弯针, RS卧式

↑ NK为NO MARK MK为有MARK

↑ XG 示意尼龙料, 1为PPS,2为PBT,3为LCP,4为ABS,5为PA6T,6为PA66

↑ G示意PIN针镀金,S为PIN针镀锡

↑ W示意针座 W后无0默认材质为V0 W后带2示意V2

东莞市羿通实业有限公司

DONGGUAN EASTOM ELECTRONIC Co., Ltd.

料号PART NO: EST3001WV-1*NPB-X				一般公差 GENERAL TOLERANCE	
品名 TITLE: MX3.0直针单排无柱				X.X ±0.35	
材料: 单位: MM 包装规格: 比例: 1:1				X.XX ±0.20	
日期版次 REVISION 日期 DATE 变更内容 DESCRIPTION 核 准 APPROVALBY				ANGLE ±1°	
制图: 审核: 核准: 日期: 2022. 4. 13					

6

5

4

3

2

1

1