

SEC A-A

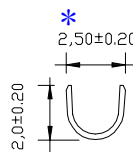

SEC B-B

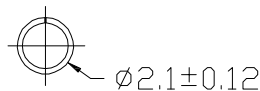

SEC C-C

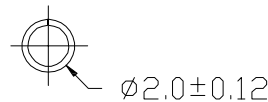

SEC D-D

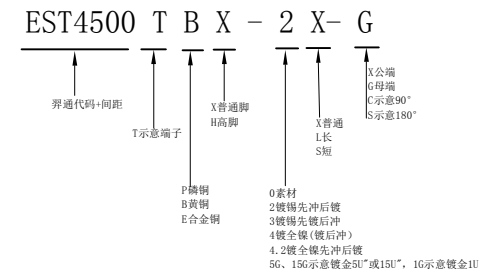

Technical parameters  
 1、Applicable wire:AWG#22-#26;  
 2、Rated voltage:600V DC/AC(rams);  
 3、Rated Current:5A AC.DC;  
 4、Withstanding voltage:1500V AC/Minute;  
 5、Working temperature:-25°C~+85°C

日期版次 REVISION	日期 DATE	变更内容 DESCRIPTION	核 准 APPROVALBY



东莞市羿通实业有限公司  
 DONGGUAN EASTOM ELECTRONIC Co., Ltd.

料号PART NO: EST4500TBX-2X-G			
品名 TITLE: 1.3-T母			
材料:	单位: MM	包装规格:	比例: 1:1
制图:	审核:	核准:	日期: 2022.8.31

一般公差 GENERAL TOLERANCE
X. X ±0.25
X. XX ±0.20
ANGLE ±1°

