

13790510059

5

4

3

2

1

EST1201 H - 1\*NP X - B - X - HF-NK - X

↑ 羿通代码+间距      ↑ X本色      ↑ X普通      ↑ X公胶壳      ↑ NO MARK      ↑ A灼热丝750  
 ↑ B黑色      ↑ B带扣      ↑ C刷版      ↑ G母胶壳      ↑ B灼热丝850  
 ↑ R红色      ↑ L蓝色      ↑ Y黄色      ↑ ZL示意两侧带锁扣      ↑ U超薄+防呆型      ↑ X普通料  
 ↑ G绿色      ↑ C透明      ↑ BV带高凸点      ↑ LC带低凸点      ↑ K卡槽      ↑ E有耳      ↑ NE无耳

PIN数  
 1示意单排  
 2示意双排

H示意胶壳,  
 H后无数字默认材质V0  
 H后带数字2示意材质V2

Specification (Abbreviation)  
 Family: Housing  
 Pitch (mm): 1.2mm  
 Operation Direction: S/R R/A  
 Current (A): AWG#28/2A; AWG#30/1.5A; AWG#32/1A  
 Insulation O. D.:  $\phi$  0.55~0.7mm (AWG#32~#28);  
 Voltage: 50 Volts AC, DC (per pin)  
 Current: 1.0A AC, DC (AWG#32)  
 1.5A AC, DC (AWG#30)  
 2.0A AC, DC (AWG#28)  
 Contact Resistance: 40 m $\Omega$  max.  
 Dielectric Withstanding Voltage: 500V DC Min.  
 Insulation Resistance: 100M $\Omega$  min.  
 Operating Temp.: -40 $^{\circ}$ C ~ +85 $^{\circ}$ C

CKT	A	B	C	D
2	1.2	3.1	2.6	3.7
3	2.4	4.3	3.8	4.9
4	3.6	5.5	5.0	6.1
5	4.8	6.7	6.2	7.3
6	6.0	7.9	7.4	8.5
7	7.2	9.1	8.6	9.7
8	8.4	10.3	9.8	10.9
9	9.6	11.5	11.0	12.1
10	10.8	12.7	12.2	13.3
11	12.0	13.9	13.4	14.5
12	13.2	15.1	14.6	15.7
13	14.4	16.3	15.8	16.9
14	15.6	17.5	17.0	17.1
15	16.8	18.7	18.2	18.3

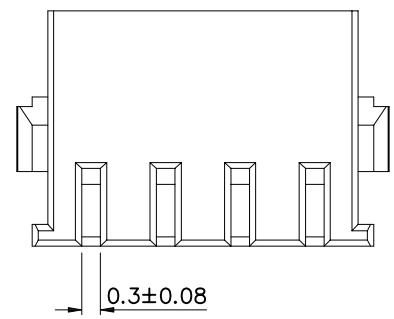
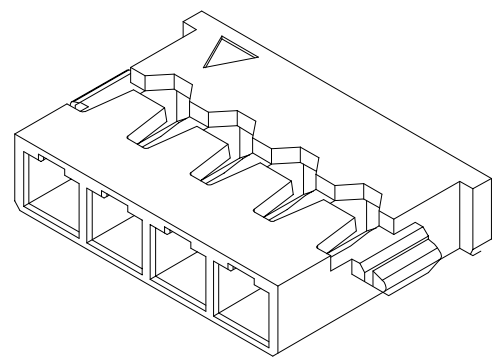
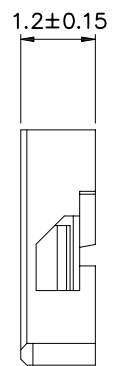
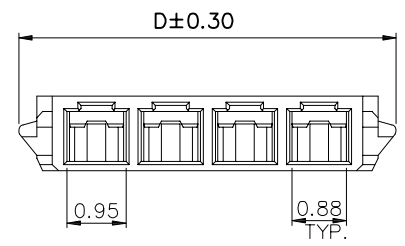
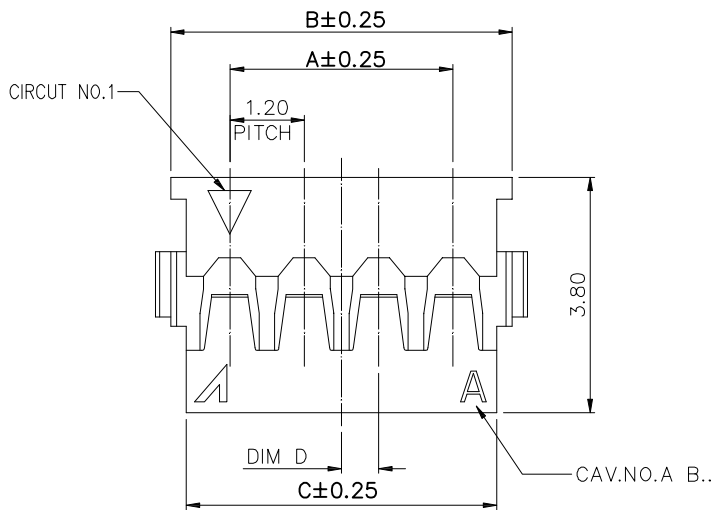

**EST**  
 DGEASTOM

**东莞市羿通实业有限公司**  
**DONGGUAN EASTOM ELECTRONIC Co., Ltd.**

料号PART NO: EST1201H-1*NPB-X				一般公差 GENERAL TOLERANCE X.X ±0.25 X.XX ±0.20 ANGLE ±1 $^{\circ}$
品名 TITLE: JST1.2-H				
材料:	单位: <b>MM</b>	包装规格:	比例: 1:1	
日期版次 REVISION	日期 DATE	制图:	日期: 2019.7.2	
变更内容 DESCRIPTION	核 准 APPROVALBY	审核:	核准:	

6

5

4

3

2

1

XES